

SUBLEVEL 3 - SECURITY ROOM 3221 - ELECTRICAL - POWER - PHASE 1
SCALE = 1/2" = 1'-0"

SUBLEVEL 3 - OPS SUITE - ELECTRICAL - POWER - PHASE 1
SCALE = 1/4" = 1'-0"

DRAWING NOTES:
 A. REFER TO DRAWING E-001P1 FOR SYMBOLS, ABBREVIATIONS, AND DRAWING CONVENTIONS.
 B. HEAVY LINE WEIGHT DESIGNATES NEW WORK, LIGHT LINE WEIGHT DESIGNATES EXISTING WORK TO REMAIN.

GHD
 GHD Inc.
 14585 Avion Prkwy Suite 150 Chantilly Virginia USA
 T 1 571 325 5000 W www.ghd.com

Mueller
 1306 Concourse Drive, Suite 100
 Linthicum, MD 21090
 410.646.4500 tel
 410.646.4738 fax
 www.muellersassoc.com

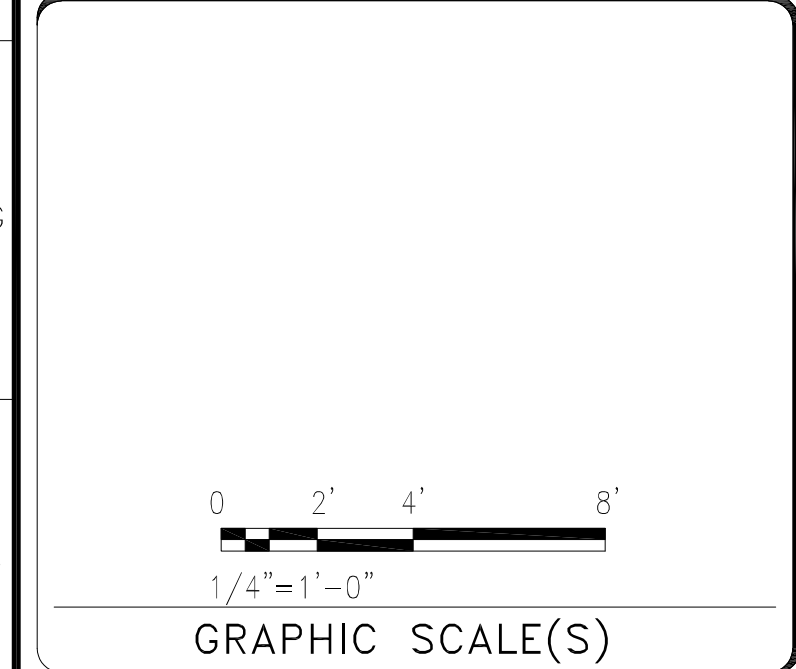
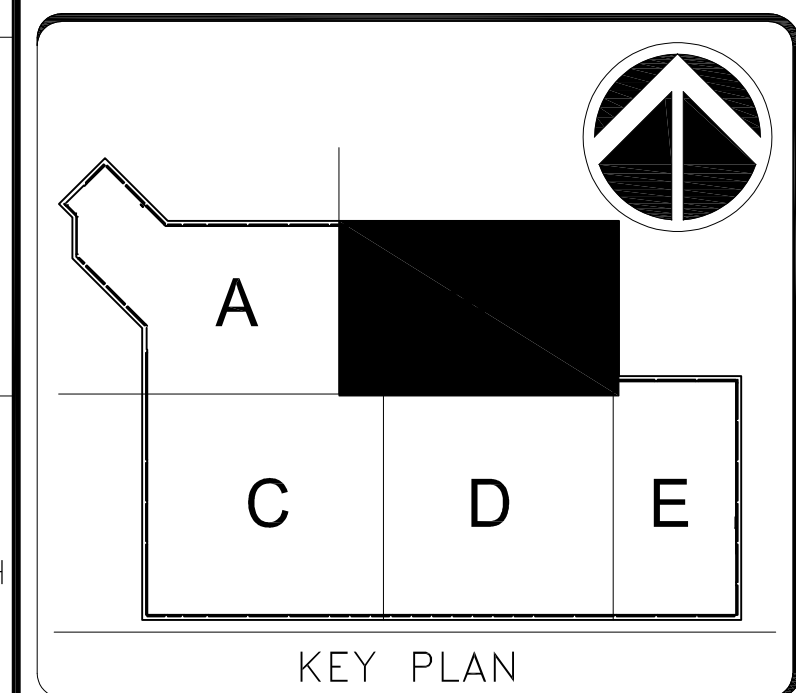

DATE 04/08/22	REVISION FINAL CD
REVISION # DATE	REVISION DESCRIPTION
1	FF&E UPDATES

Smithsonian Institution
 Smithsonian Facilities
 600 Maryland Avenue S.W. Suite 5001
 Washington, DC 20024-2520

DESIGNED BY FREER/SACKLER/AFA/QUAD	ADDRESS SW WASHINGTON, DC 20560
PROJECT TITLE FREER/SACKLER/AFA/QUAD ESS MODERNIZATION	SF PROJECT NUMBER 1909101
A/E PROJECT NUMBER 11203201	DRAWING TITLE SUBLEVEL 3 - OPS SUITE - ELECTRICAL - POWER - PHASE 1
WORKING STAFF SNA SNA CEC	DESIGNED BY SNA SNA CEC

SHEET NO. 105 of 179
E - 4 0 2 E P P 1

6/10/2022 9:57:33 AM
 E-402EPP1 BY: Approver: 04/08/22 FINAL CD